

Swimming Upstream

by Dianne Gardner

April

B.O.M 2020

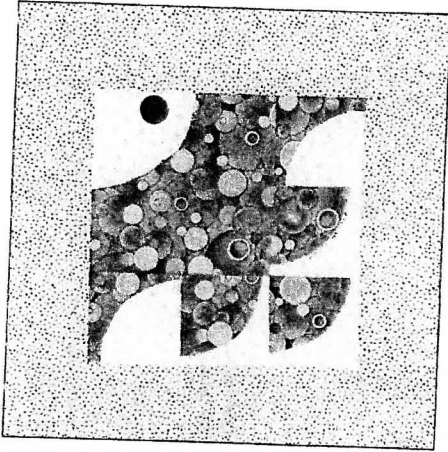

Brown Print

2 squares (A) 3" x 3"

3 pattern B

1 square (C) 5 1/2" x 5 1/2"



Unit 1

Make 2



Unit 2

Make 3

Cream Dot

3 squares (A) 3" x 3"

2 pattern B

1 pattern D

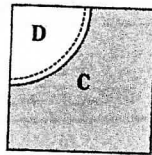

Unit 3

Make 1

Blue Dot

2 rectangles (E) 2 3/4" x 8"

2 rectangles (F) 2 3/4" x 12 1/2"

Button 1 at 3/4"

Align a cream B in one corner of a brown A as shown. Using cream thread and a machine straight stitch, sew 1/4" from the curved edge of B to make a unit 1. Repeat to make 2 unit 1's. Repeat with the cream A's and brown B's to make 3 unit 2's. Use the brown C and cream D to make a unit 3. The raw edges of the appliqué will fray.

Sew the units and patches together as shown. Sew the button in place to complete the block.

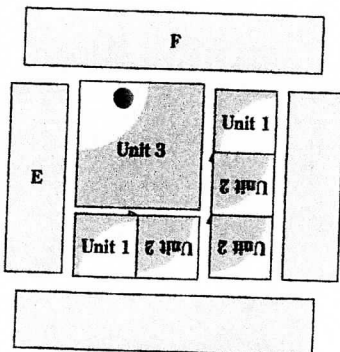

Block Assembly